



STM GEN 2 TUNER SECONDARY



2015 Polaris RZR XP1000

Part # 2001011

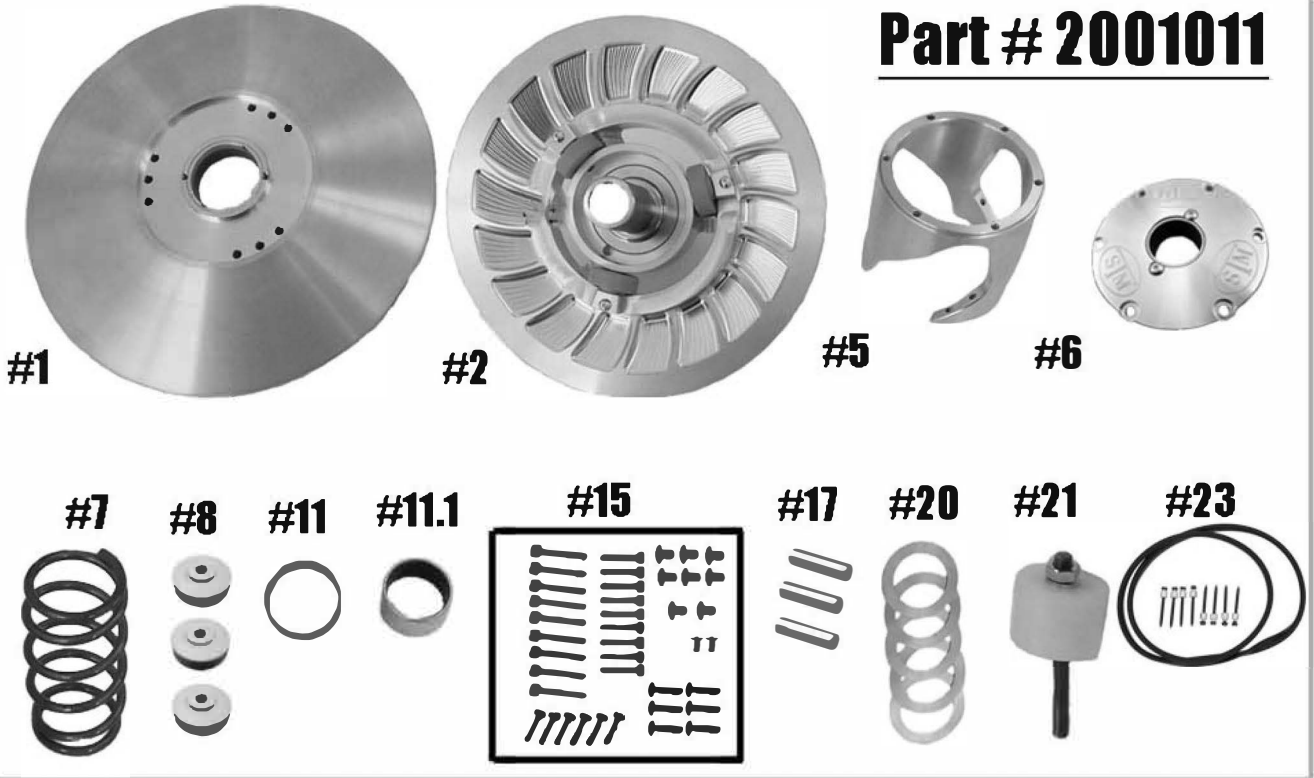

QTY	ITEM#	DESCRIPTION	PART#
1	1	GEN 2 MOVABLE SHEAVE	2001012
1	2	GEN 2 FIXED SHEAVE & POST ASSEMBLY	2001231/2001014
1	5	GEN 2 HELIX	HXATVG2
1	6	COVER	1001304
1	7	PS or KSS STYLE SPRING	PER APPLICATION
3	8	TUNER GEN 2 ROLLER	1001008
1	11	MOVABLE SHEAVE	2408
1	11.1	BUSHING COVER BUSHING	3020-10
1	15	TUNER FASTENER KIT	1001034
3	17	1/4" X 1" PULL DOWEL	1/4"x1"PD
1	20	BELT DEFLECTION SHIM SET of 6	C157712
1	21	BELT REMOVAL TOOL - M10X1.25	2001116
1	23	CLUTCH HOUSING SPACER KIT	2001006
	N/A	USE STOCK CLUTCH BOLT (Torque to factory specifications)	N/A

**** PLEASE VISIT WEBSITE FOR ITEM PRICING ****

STM Powersports
(248) 673-8408

www.stmpowersports.com

10/19/2022