

# STM POWERSPORTS TUNER

## APEX - Z1 (2011-15) XP 900 CONVERSION

**PART# 2001067**

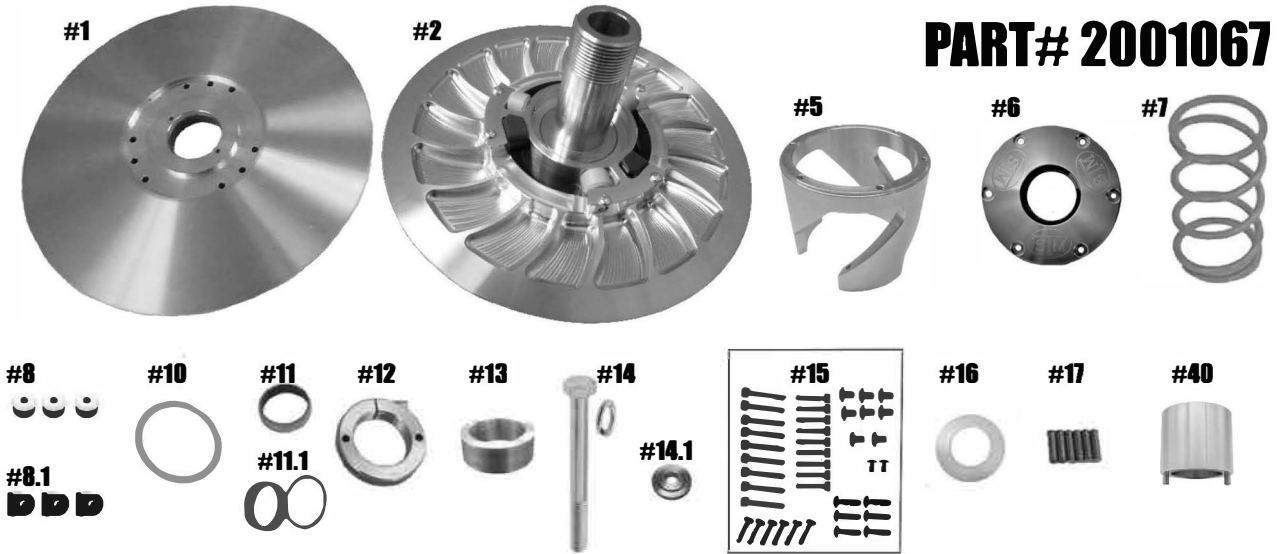

| QTY | ITEM#     | DESCRIPTION                                       | PART #            |
|-----|-----------|---|-------------------|
| 1   | 1         | MOVABLE SHEAVE                                    | 2001062           |
| 1   | 2         | FIXED SHEAVE & POST                               | 2001063 / 2001068 |
| 1   | 5         | HELIX   | HXATV             |
| 1   | 6         | COVER   | 1001067           |
| 1   | 7         | KSS STYLE SPRING                                  | PER APPLICATION   |
| 3   | 8         | ROLLER  | 1001047           |
| 3   | 8.1       | BUTTON  | 1001048           |
| 1   | 10        | SPRING WASHER                                     | 1001049           |
| 1   | 11        | MOVABLE BUSHING                                   | 2408              |
| 1   | 11.1      | COVER BUSHING w/ VH175 RETAINING CLIP             | 2408              |
| 1   | 12        | ADJUSTMENT NUT                                    | 1001059           |
| 1   | 13        | RESISTANCE SPACER                                 | 2001066           |
| 1   | 14        | RETAINING BOLT & LOCK WASHER (M10x1.25x75mm HHCS) | 2001144           |
| 1   | 14.1      | BOLT RETAINING WASHER                             | 2001069           |
| 1   | 15        | TUNER FASTENER KIT                                | 1001034           |
| 1   | 16        | ADJUSTMENT NUT THRUST WASHER                      | 1001060           |
| 6   | 17        | 1/4" x 1" PULL DOWEL                              | 1/4"x1"PD         |
| 1   | 40        | ADJUSTMENT NUT SOCKET TOOL                        | 1001064           |
| 1   | NOT SHOWN | OPTIONAL TORSIONAL CONVERSION UPGRADE             | 1001080           |

**\* \* \* Please visit website for item pricing \* \* \***

STM Powersports  
(248) 673-8408

[www.stmpowersports.com](http://www.stmpowersports.com)

1/24/2023