

STM TUNER INSTRUCTIONS

GEN II POLARIS TUNER DRIVEN

PART# 2001073T

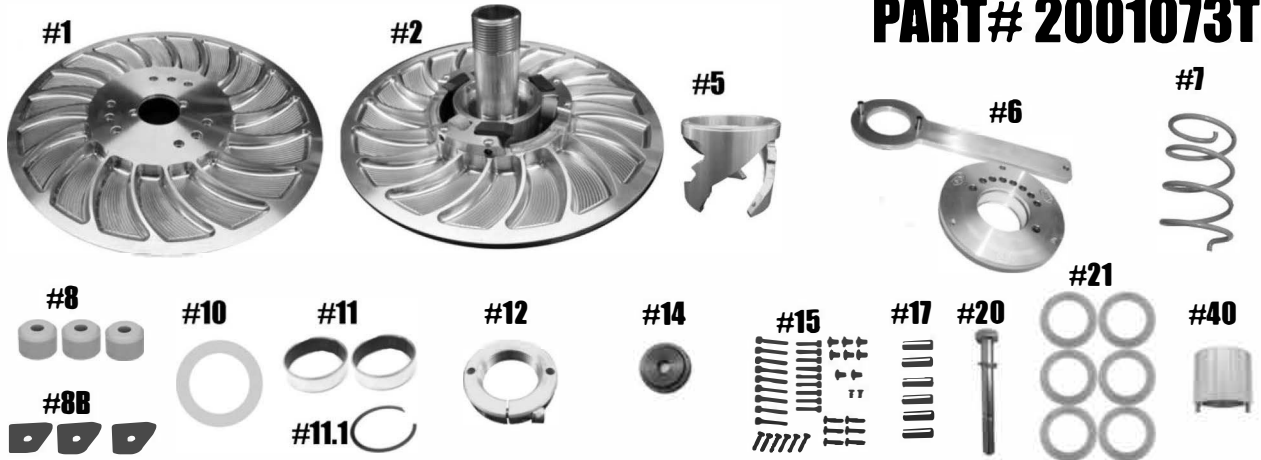

QTY	ITEM#	Description	Part #
1	1	MOVABLE SHEAVE	2001076
2	2	FIXED SHEAVE ASSY / POST	2001075 / 2001077
1	5	HELIX	HXSM 2S
1	6	TORSIONAL SPRING UPGRADE CAP (1001078) TOOL (1001079)	KIT (contains both) 1001080
1	7	TORSIONAL SPRING	PER APPLICATION
3	8	ROLLER	1001047
3	8B	REVERSE BUTTONS	1001077
1	10	ADJUSTER NUT WASHER	1001060
2	11	COVER AND MOVABLE SHEAVE BUSHING	2408
1	11.1	BUSHING RETAINING	VH175
1	12	CLIP ADJUSTMENT NUT	1001059
1	14	RETAINING WASHER	2001074
1	15	TUNER BOLT KIT* (INCLUDES 15,18,19)	1001034
6	17	HARDENED ROLLER PIN	¼"x1"PD
1	20	SECONDARY RETAINING BOLT & LOCK WASHER	M10-1.25x55
1	21	OFFSET SHIMS SET OF 6	C157843-6
1	40	ADJUSTER NUT TOOL	1001064

***** Please visit website for item pricing *****

STM Powersports

(248) 673-8408

www.stmpowersports.com

1/24/2023