

STM POWERSPORTS TUNER

APEX - Z1 (2016-20) XP1000 CONVERSION

PART# 2001143

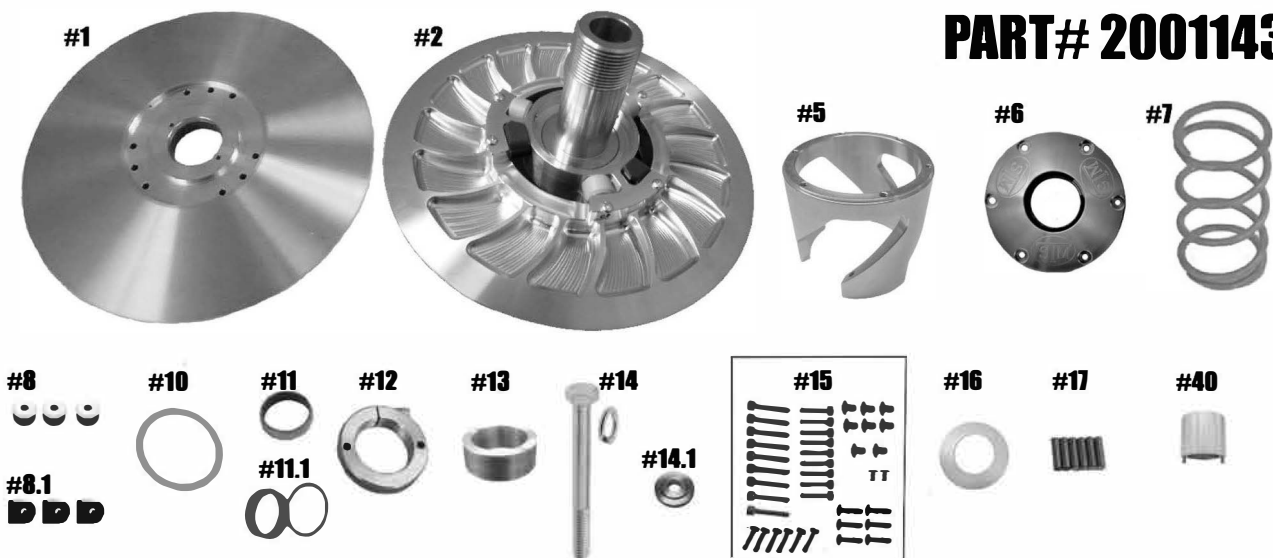

QTY	ITEM#	DESCRIPTION	PART #
1	1	MOVABLE SHEAVE	2001062
1	2	FIXED SHEAVE & POST ASSEMBLY	2001063/2001117
1	5	HELIX	HXATV
1	6	COVER	1001067
1	7	KSS STYLE SPRING	PER APPLICATION
3	8	ROLLER	1001047
3	8.1	BUTTONS	1001048
1	10	SPRING WASHER	1001049
1	11	MOVABLE BUSHING	2408
1	11.1	COVER BUSHING w/VH175 RETAINING CLIP	2408
1	12	ADJUSTMENT NUT	1001059
1	13	RESISTANCE SPACER	2001066
1	14	RETAINING BOLT & LOCK WASHER (M10x1.25x75mm HHCS)	2001144
1	14.1	BOLT RETAINING WASHER	2001110
1	15	TUNER FASTENER KIT	1001034
1	16	ADJUSTMENT NUT THRUST WASHER	1001060
6	17	1/4" X 1" PULL DOWEL	1/4"x1"PD
1	40	ADJUSTMENT NUT SOCKET TOOL	1001064
1	NOT SHOWN	OPTIONAL TORSIONAL CONVERSION	1001080

***** Please visit website for item pricing *****

STM Powersports
(248) 673-8408

www.stmpowersports.com

1/24/2023