



# STM GEN 2 FINNED TUNER SECONDARY



## 2016-23 Polaris RZR XP1000 & 2016 -22 RZR

### XP900

## Part # 2001145

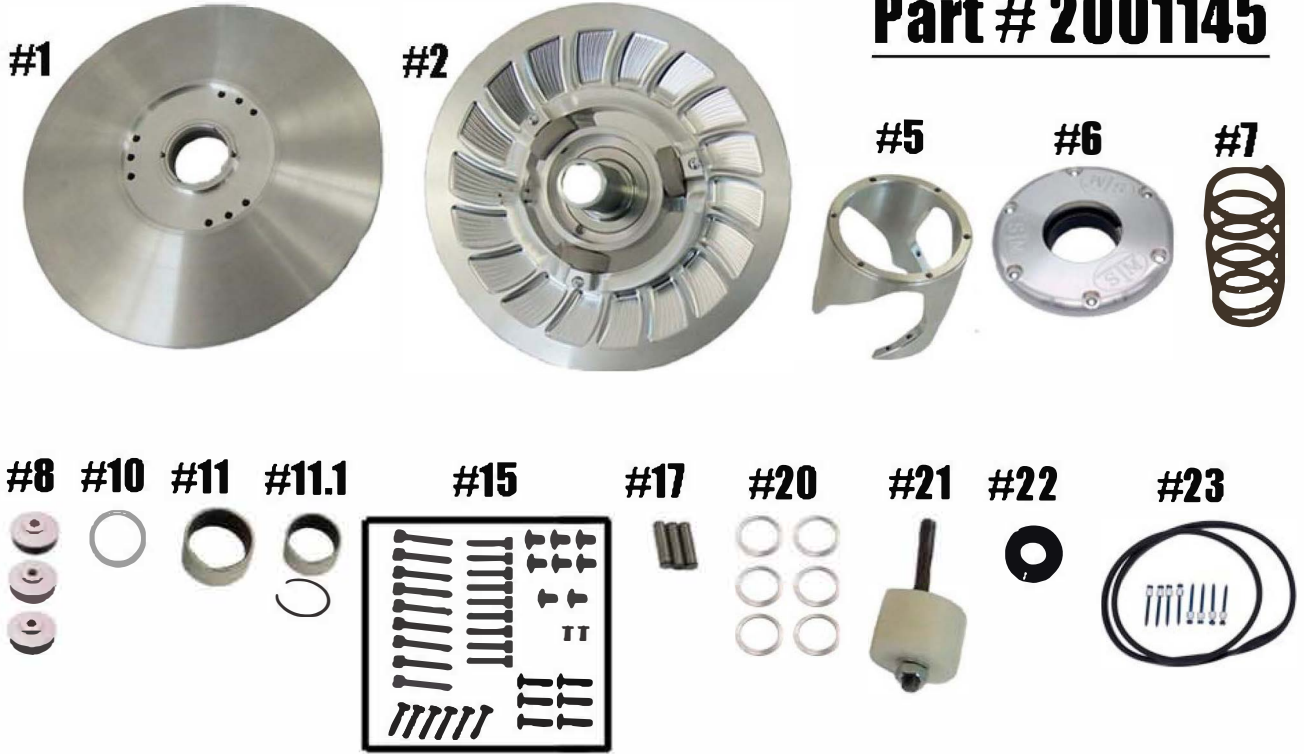

ITEM#	PART#	DESCRIPTION	QTY
1	2001012	GEN 2 TUNER SECONDARY MOVABLE SHEAVE 1.5" BUSHING ID	1
2	2001212/2001114	TUNER SECONDARY GEN 2 FINNED FIXED SHEAVE ASSEMBLY	1
5	HXATVG2	GEN 2 ATV HELIX	1
6	1001067	HD COMPRESSION SPRING HELIX COVER	1
7	ATVSS	ATV KSS STYLE SPRING	1
8	1001008	TUNER GEN 2 ROLLER	3
11	2408	MOVABLE SHEAVE BUSHING	1
11.1	2408 / VH175	COVER BUSHING W/ RETAINING CLIP	1
15	1001034	TUNER SECONDARY FASTENER KIT (Torque specs on back page)	1
17	¼"x1"PD	TUNER SECONDARY ROLLER PIN ¼" X 1" PULL DOWEL	3
20	C157712	ATV TUNER BELT DEFLECTION SHIM SET of 6 1.5" ID	1
21	2001116	BELT REMOVAL TOOL - M10X1.25	1
22	2001110	SECONDARY BOLT RETAINING WASHER	1
23	2001006	CLUTCH HOUSING COVER SPACER KIT	1
N/A	N/A	USE STOCK CLUTCH BOLT	

**\*\* PLEASE VISIT WEBSITE FOR ITEM PRICING \*\***

STM Powersports  
(248) 673-8408

[www.stmpowersports.com](http://www.stmpowersports.com)

7/14/2023