

STM TUNER INSTRUCTIONS

GEN II POLARIS 850 SNOWMOBILE TUNER DRIVEN

PART# 2001248T

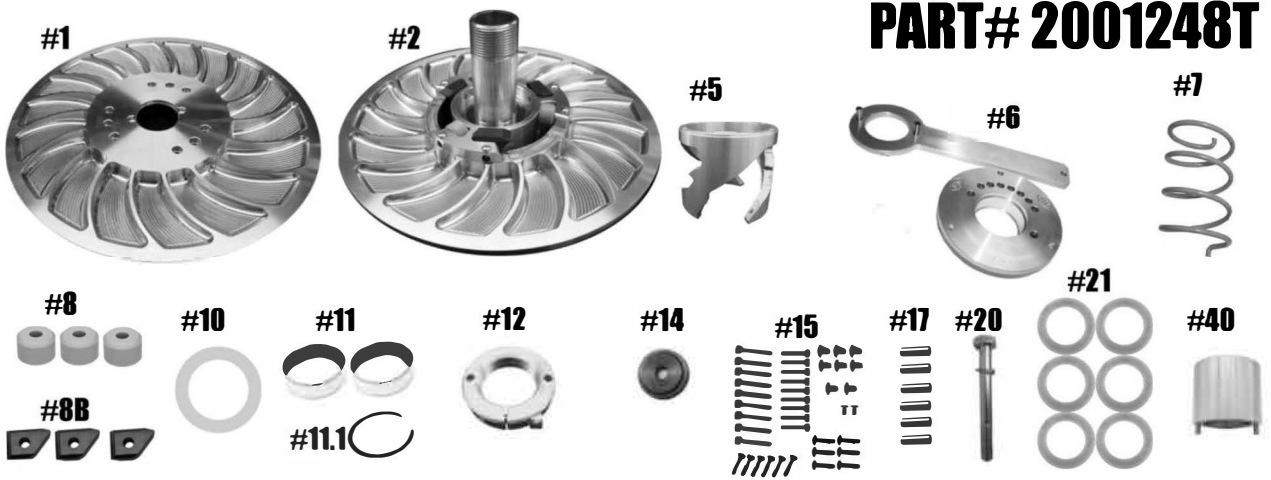

| QTY | ITEM# | Description | Part # |
|-----|-------|---|--------------------------------|
| 1 | 1 | MOVABLE SHEAVE | 2001076 |
| 2 | 2 | FIXED SHEAVE ASSY / POST | 2001075 / 2001077 |
| 1 | 5 | HELIX | HXSM 2S |
| 1 | 6 | TORSIONAL SPRING UPGRADE CAP (1001078) TOOL (1001079) | (includes both) KIT 1001080 |
| 1 | 7 | TORSIONAL SPRING | ATVTS |
| 3 | 8 | ROLLER | 1001047 |
| 3 | 8B | REVERSE BUTTONS | 1001077 |
| 2 | 10 | ADJUSTER NUT WASHER | 1001060 |
| 2 | 11 | COVER AND MOVABLE SHEAVE BUSHING | 2408 |
| 1 | 11.1 | BUSHING RETAINING CLIP | VH175 |
| 1 | 12 | ADJUSTMENT NUT | 1001059 |
| 1 | 14 | RETAINING WASHER | 2001242 |
| 1 | 15 | TUNER BOLT KIT | 1001034 |
| 6 | 17 | HARDENED ROLLER PIN | ¼"x1"PD |
| 1 | 20 | SECONDARY RETAINING BOLT (M10-1.25x45mm) & HIGH COLLAR LOCK WASHER | M10-1.25 x 45MM SHCS |
| 1 | 21 | OFFSET SHIMS SET OF | C157843-6 |
| 1 | 40 | 6 ADJUSTER NUT TOOL | 1001064 |

*** * * Please visit website for item pricing * * ***