

# STM RAGE 3WCP POLARIS RZR PRO XP, XP-TURBO, XP-TURBO S & RS1 PRIMARY

**Part # 2001255**

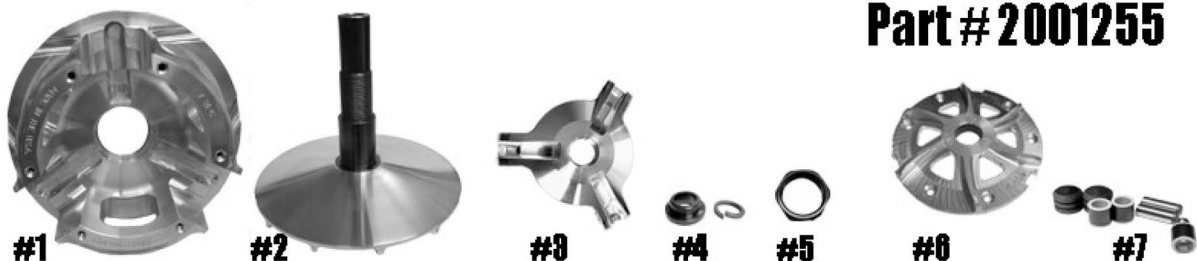

**SOLD SEPARATELY**

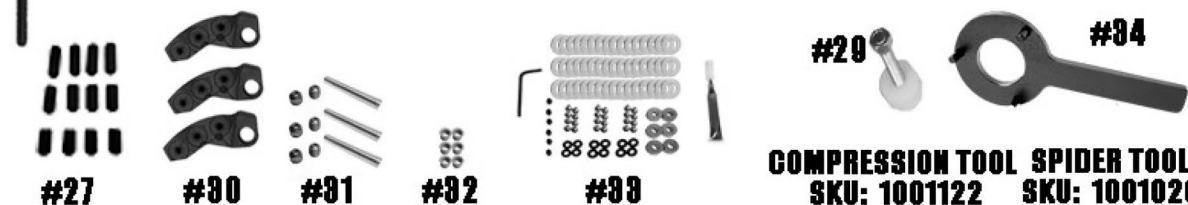

**COMPRESSION TOOL SKU: 1001122 SPIDER TOOL SKU: 1001020**

ITEM#	PART #	DESCRIPTION	QTY
1	2001254	RAGE 3WCP PRIMARY WIDE CAPTURED PIN MOVABLE SHEAVE w/TURNED ANGLE 8.5"	1
2	2001260/2001272	FIXED SHEAVE AND POST ASSEMBLY for RAGE PRIMARY	1
3	1001572	RAGE 3 WIDE SPIDER (Torque to 500 ft./lb.)	1
4	1001540	PRIMARY M14 RETAINING WASHER & Lock Washer	1
5	3001005	SPIDER NUT RAGE PRIMARY (Torque to 550 ft./lb.)	1
6	1001590	ATV RAGE 3 WIDE PRIMARY FINNED COVER	1
7	1001642	3 ARM WIDE SPIDER KIT w/ COMPOSITE ROLLER BUSHINGS .610 ROLLER	1
13	1001189	CLUTCH PULLER FOR STM PRIMARY 5/8"-18x12.057"	1
14	1001657	RAGE PRIMARY M14-1.5 x 8.5" RETAINING BOLT (Torque to 85 ft./lb.)	1
15	1001004/ VH225	MOVABLE BUSHING w/ RETAINING CLIP	1
16	1810.590/ VH131	COVER BUSHING w/ RETAINING CLIP	1
17	1001018	ATV RAGE 3 & 6 PRIMARY COVER SCREW SET (torque to 105 in./lb.)	1
18	1001000	SLEEVED 2-WAY BEARING 47MM	1
19	1001019	ATV PRIMARY BEARING CLUTCH THRUST WASHER	2
20	2001252	RAGE PRIMARY WIDE BEARING CAP	1
21	1001276	PRIMARY SPRING SPACER .125 SHIM	1
27	1001094	CAM ARM POSITIONING ADJUSTMENT SET SCREW SET	1
29	1001122	RAGE SNOWMOBILE & UTV PRIMARY COMPRESSION TOOL 5/8"-18 (Sold Separately)	1
30	50 GRAM BASE - 1001585	OR 60 GRAM BASE - 1001584	CAM ARM-HB STYLE
	50 GRAM BASE - 2001151	OR 60 GRAM BASE - 2001245	CAM ARM-AFP STYLE
31	1001594	CAM ARM PIN & SET SCREW	3
32	1001588	CAM ARM BUSHING SET for CAPTURE PIN PRIMARY USING .570 WIDE WEIGHT (2)	3
33	30 FK 3	3 ARM SUPERTIP CAM ARM TUNING FASTNER KIT	1
34	1001020	RAGE 3 & 6 SPIDER TOOL (Sold Separately)	1

**\* \* \* Please visit website for item pricing \* \* \***

**It's important to completely read the directions before installing the clutch!**



STM Powersports  
(248) 673-8408

[www.stmpowersports.com](http://www.stmpowersports.com)



8/28/2023