

# STM POWERSPORTS TUNER SECONDARY

## Can-Am Long Post Gen 2

**Part# 3001018**

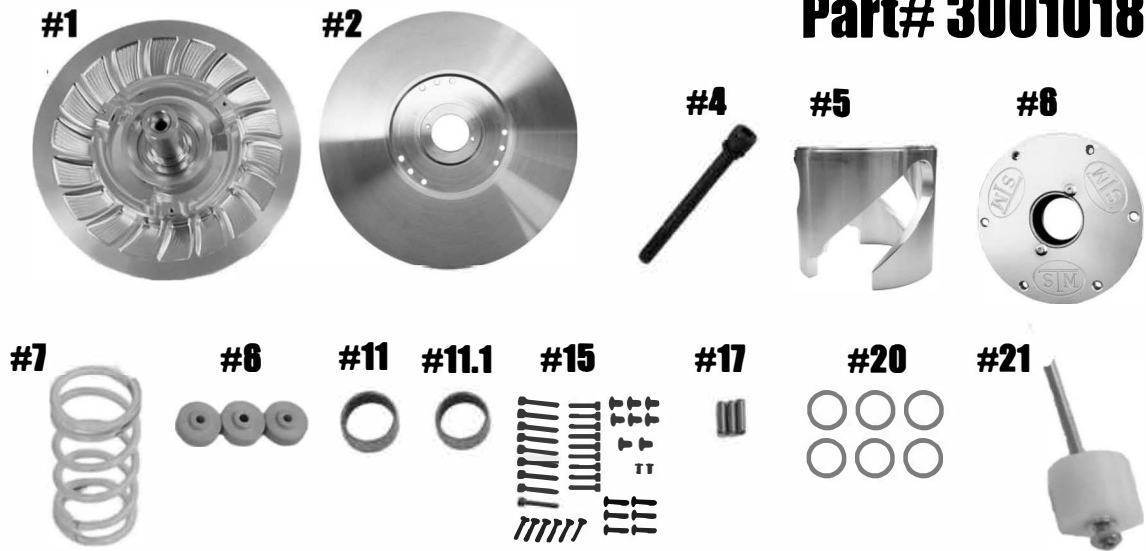

<u>Item#</u>	<u>PART#</u>	<u>DESCRIPTION</u>	<u>QTY</u>
1	3001020/3001002	LONG POST TUNER GEN 2 FIXED SHEAVE AND POST ASSY	1
2	3001019	TUNER GEN 2 MOVABLE SHEAVE	1
4	3001021	TUNER BOLT & LOCKWASHER (M10x1.5x105mm SHCS) -Torque to 40 ft/lbs.	1
5	HXATVG2	GEN 2 ATV HELIX	1
6	1001304	ATV TUNER COVER 1.81" DIA BUSHING	1
7	PER APPLICATION	KSS or PS STYLE SPRING	1
8	1001008	TUNER GEN 2 ROLLER	3
11	3020.56	ATV TUNER MOVABLE SHEAVE BUSHING	1
11.1	3020-10	COVER BUSHING (.78 TALL)	1
15	1001034	TUNER SECONDARY FASTENER KIT - Torque Specs on Back Page	1
17	¼"x1"PD	TUNER SECONDARY ROLLER PIN ¼"X 1" PULL DOWEL	3
20	95601A435	TUNER BELT DEFLECTION SHIM SET of 6	1
21	3001022	ATV TUNER BELT REMOVAL TOOL ½" - 13	1

**\*\* PLEASE VISIT WEBSITE FOR ITEM PRICING \*\***