

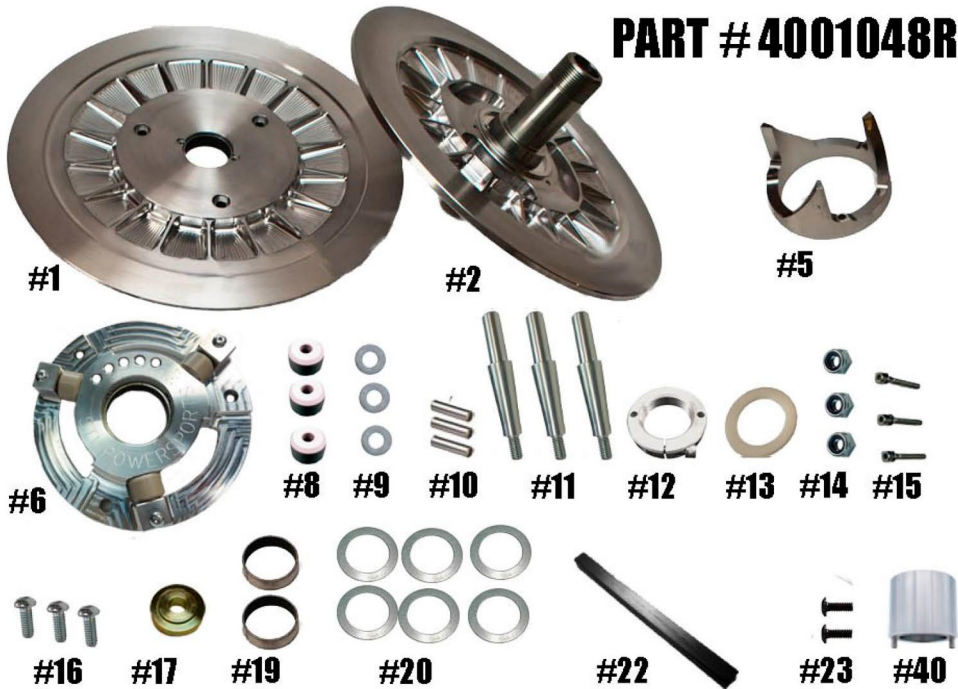

STM GEN I TUNER SECONDARY 1" SHAFT

1/4" KEY - ROLLER COVER

PART # 4001048R



Item#	Part #	Description	QTY
1	1001617	GEN 1 TUNER MOVABLE SHEAVE ASSY 1" SHAFT 1/4" KEY	1
2	1001618	GEN 1 TUNER FIXED SHEAVE ASSY 1" SHAFT 1/4" KEY	1
5	HXAC (Designate Angle)	OLD STYLE ARCTIC CAT HELIX	1
6	1001055	BILLET GEN 1 TUNER ROLLER COVER	1
8	1001047	TUNER GEN 1 ROLLER	3
9	C164368	STEEL WASHER SET (6)	1
10	1/4"X1"PD	TUNER SECONDARY ROLLER PIN-1/4" X 1 " PULL DOWEL	3
11	1001057	ROLLER COVER POST	3
12	1001059	TUNER ADJUSTER NUT	1
13	1001060	ADJUSTER NUT THRUST WASHER	1
14	1001061	NYLOC LOCKNUT 5/16"X18 (Torque to 20 ft/lbs.)	3
15	1001062	OLD STYLE ARCTIC CAT HELIX RETAINING SCREWS & LOCK WASHER SET (3)	1
16	1001063	ROLLER COVER POST RETAINING BOLT SET (3)	1
17	4001049	KEYED SHAFT SECONDARY TUNER RETAINING WASHER	1
19	2408	COVER & MOVABLE BUSHING	2
20	C157843	1" DIA SHAFT SECONDARY OFFSET SHIM (6)	1
22	4001056	1/4" KEYED SHAFT KEY	1
23	8/32x3/8BHCS	BUSHING RETAINING SCREW SET (2)	1
40	1001064	ADJUSTER NUT TOOL	1

***** Please visit website for item pricing *****

It's important to completely read the directions before installing the clutch!

STM Powersports

(248) 673-8408

www.stmpowersports.com

7/24/2023