

# STM GEN 2 TUNER INSTRUCTIONS

## 16-23 ARCTIC CAT 8000 Series

**Part # 4001130T**

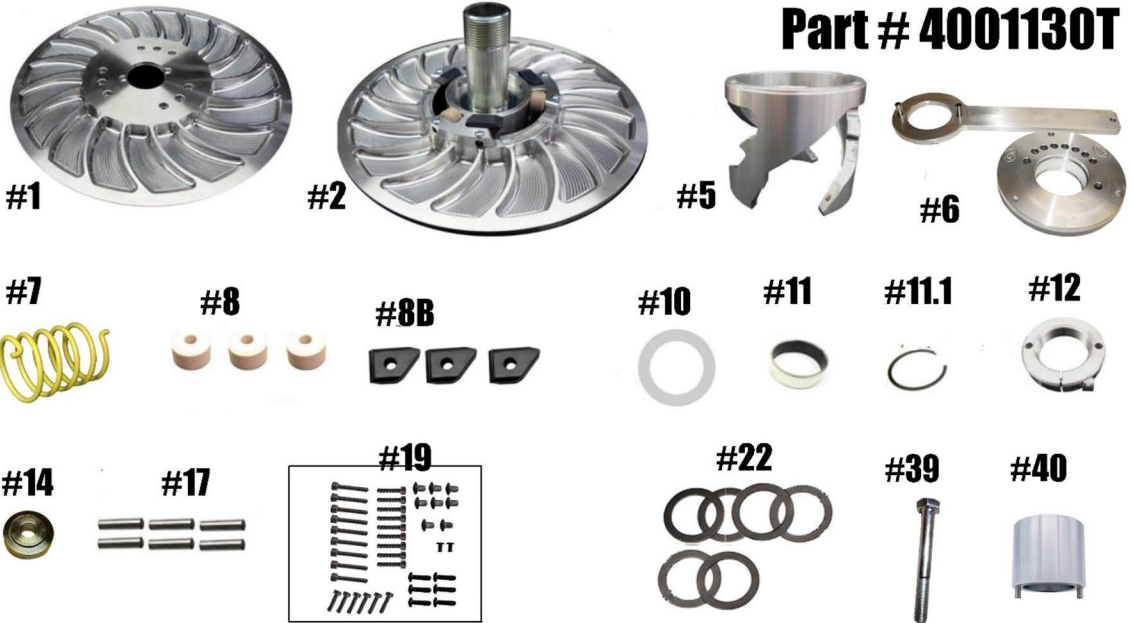

ITEM#	Part #	Description	QTY
1	4001166	MOVABLE SHEAVE	1
2	4001167	FIXED SHEAVE / POST ASSY	1
5	HXSM 2S	AC 800/8000 SERIES, POLARIS 850 & SKI-DOO E-TEC 850 STM GEN 2 HELIX	1
6	1001080	TORSIONAL SPRING COVER (1001078) / TORSION TOOL (1001079)	1
7	ATVTS	ATV TORSIONAL TUNER SPRING	1
8	1001047	TUNER GEN 1 ROLLER	3
8B	1001077	GEN 2 REVERSE BUTTON	3
10	1001060	ADJUSTMENT NUT THRUST WASHER	1
11	2408	COVER AND MOVABLE SHEAVE BUSHING	2
11.1	VH175	COVER BUSHING RETAINING RING	1
12	1001059	ADJUSTMENT NUT	1
14	2001110	RETAINING WASHER	1
17	¼"x1"PD	TUNER SECONDARY ROLLER PIN ¼"x1" PULL DOWEL	6
19	1001034	TUNER FASTENER KIT	1
22	98055A325-6	OFFSET SHIM SET (6)	1
39	2001144	BOLT (M10x1.25x75mm HHCS) & M10 LOCKWASHER (Torque to 60 ft/lbs)	1
40	1001064	ADJUSTER NUT TOOL	1

\* \* \* Please visit website for item pricing \* \* \*

**It's important to completely read the directions before installing the clutch!**

STM Powersports  
(248) 673-8408

[www.stmpowersports.com](http://www.stmpowersports.com)

7/25/2023