

YAMAHA 2011-13 NITRO, 2014-16 VIPER, 2017-22 SIDEWINDER GEN 1 STM TUNER INSTRUCTIONS

PART # 5001009R

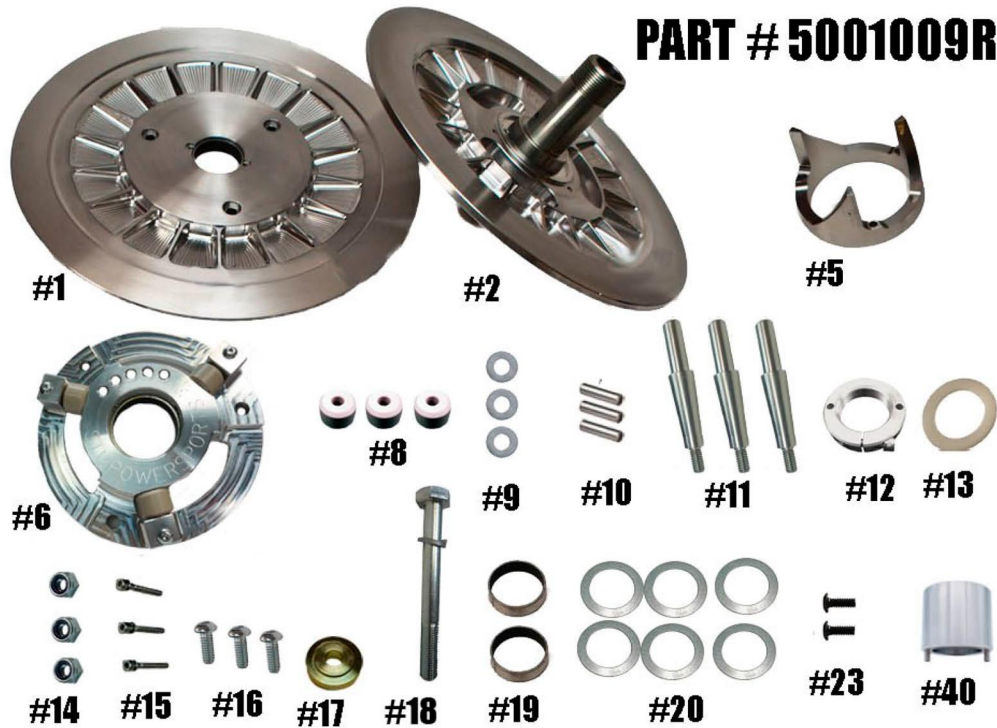

ITEM#	PART #	DESCRIPTION	QTY
1	5001007	MOVABLE SHEAVE	1
2	5001008 / 5001006	FIXED SHEAVE ASSY	1
5	HXAC	HELIX	1
6	1001055	BILLET ROLLER COVER	1
8	1001047	ROLLERS	3
9	C164368-3	STEEL WASHER SET	1
10	¼"X1"PD	SECONDARY ROLLER PIN - ¼" x 1" PULL DOWEL	3
11	1001057	ROLLER COVER POST	3
12	1001059	ADJUSTER NUT	1
13	1001060	ADJUSTER NUT THRUST WASHER	1
14	1001061	NYLOC LOCKNUT (Torque to 20 ft/lbs)	3
15	1001062	HELIX SCREW SHCS and LOCKWASHER	3
16	1001063	POST SCREW	1
17	5001004	RETAINING WASHER FOR M10 for SW/Viper	1
18	M10-1.25X90mm HHS	FOR M-10 APPLICATION for SW/Viper (Torque to 29 ft/lbs)	1
		or	
17	5001046	RETAINING WASHER FOR M18 for Nitro	1
18	M18-1.5x90mm HHS	FOR M-18 APPLICATION for Nitro (Torque to 29 ft/lbs)	1
19	2408	COVER BUSHING	1
20	98055A325-6	OFFSET SHIM SET	1
19	2408	MOVABLE BUSHING	1
23	8-32X3/8BHCS	BUSHING RETAINING SCREWS	2
40	1001064	TUNER ADJUSTER NUT TOOL	1

*** Please visit website for item pricing ***

STM Powersports

(248) 673-8408

www.stmpowersports.com

7/25/2023